

**TOWER SLOPE (FOR NORMAL TOWER)**  
 Tan B = 0.090682  
 2 Tan B = 0.181364  
 Face = 1.004112  
 Dev = 1.008208  
**In Face Slopes**  
 Tan B = 0.090410  
 Sec B = 1.004079

**TOWER SLOPE (FOR CAGE PART)**  
 Tan B = 0.090682  
 2 Tan B = 0.181364  
 Face = 1.004112  
 Dev = 1.008208  
**In Face Slopes**  
 Tan B = 0.090410  
 Sec B = 1.004079

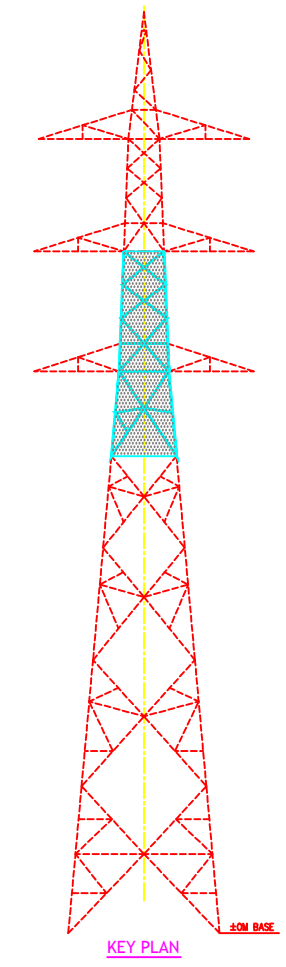
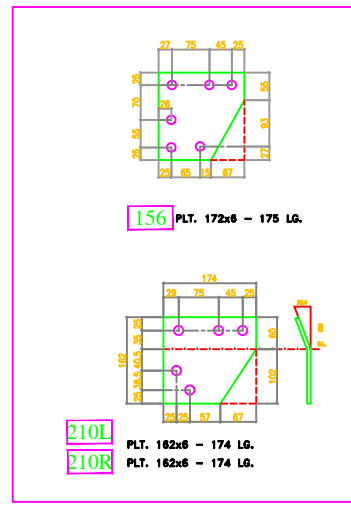
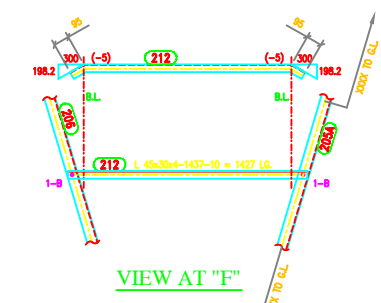
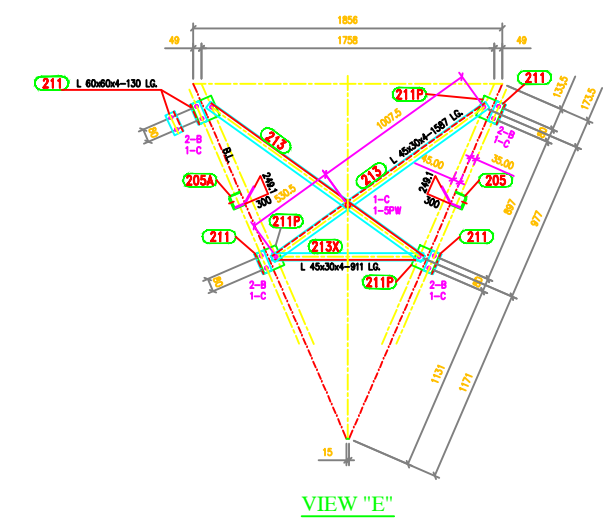
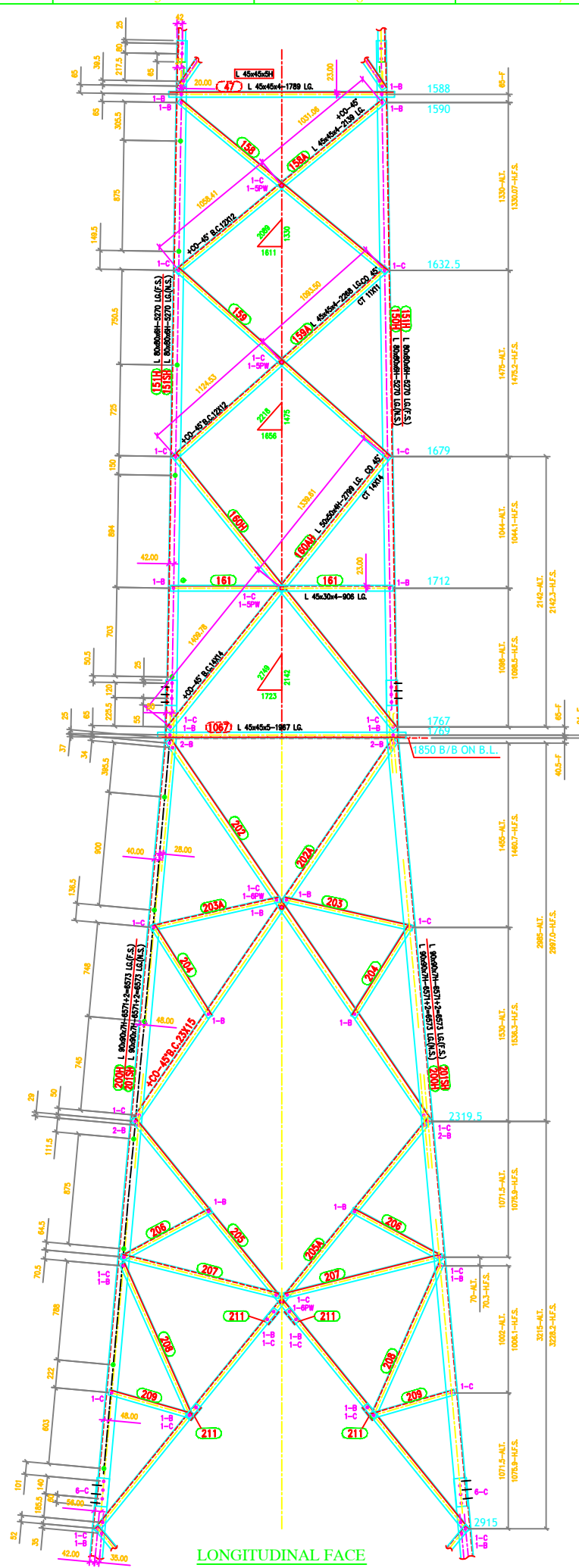
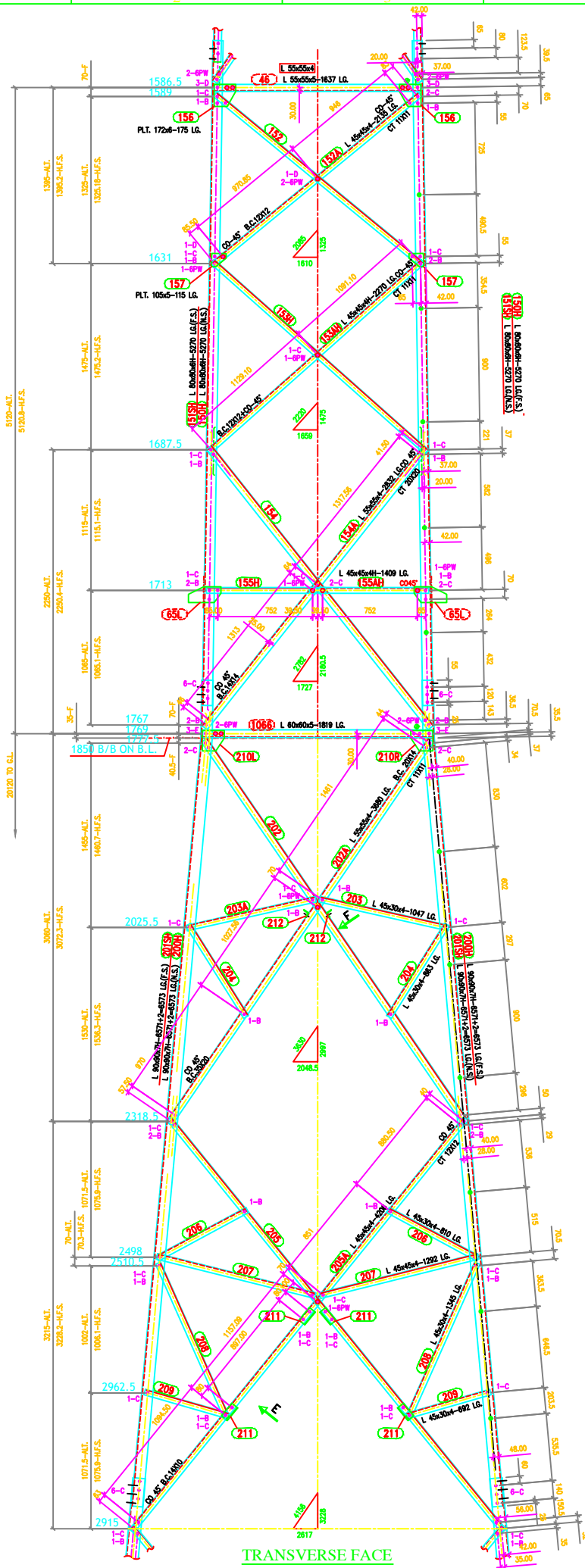

BOLTS AND NUTS STATEMENT:			
TYPE	SIZE (IN mm)	QUANTITY	
B	#16mm x 35mm	196	-
C	#16mm x 40mm	164	-
D	#16mm x 45mm	24	-
E	#16mm x 50mm	12	-
F	#16mm x 55mm	-	-
G	#16mm x 60mm	-	-
H	#16mm x 65mm	-	-
J	#16mm x 70mm	-	-
K	#16mm x 75mm	-	-
L	#16mm x 80mm	-	-
SPRING WASHERS #17.5mm		396	-
30 O.D. PACKING WASHERS #17.5mm		-	-
	5 mm	20	-
	6 mm	38	-
	8 mm	2	-
	10 mm	-	-
STEP BOLTS # 16mm x 175mm		46	-

- GENERAL NOTES:**
- ALL DIMENSIONS ARE IN MM UNLESS OTHERWISE STATED.
  - MILD STEEL BOLTS & NUTS TO IS 6839/12427/4.8/5.6 QLT.
  - ALL MILD STEEL BOLTS & NUTS ARE TO BE HOT DIP GALVANIZED AS PER IS 1367 PART-08.
  - ALL MILD STEEL BOLTS & NUTS ARE TO BE QUALITY CONFORMING TO IS. 2062 STANDARD.
  - GALVANIZATION OF TOWER MEMBERS AND FLAT WASHERS AS PER IS. 2029.
  - ALL HOLES #13.5 FOR M12 BOLTS U.O.S.
  - ALL HOLES #17.5 FOR M16 BOLTS U.O.S.
  - ALL HOLES #21.5 FOR M20 BOLTS U.O.S.
  - ALL HOLES #17.5 FOR M16 STEP BOLTS U.O.S.
  - STANDARD SPRING WASHERS ARE TO BE USED UNDER EACH NUT.
  - ALL FABRICATED MEMBERS SHALL HAVE THE PREFIX "2DA".
  - FOR SIZE OF BOLTS AND NUTS SEE TABLE OT-100.
  - INDICATES MEMBERS BEING USED AS STEP-BOLTS.
  - FOR ..... SEE DIRG. NO. S .....
  - FOR ..... SEE DIRG. NO. S .....
  - FOR ..... SEE DIRG. NO. S .....
  - FOR ..... SEE DIRG. NO. S .....
  - (H) HEIGHTS HIGH TENSILE STEEL CONFORMING TO BE 430 OR-508 QUALITY.
  - FOR ACCEPTANCE CRITERIA REFER MANUFACTURING QUALITY PLAN MPD-701.
  - CRITICAL DIMENSIONS ARE SHOWN IN .....
  - STEP BOLTS SHALL BE DIAGONALLY OPPOSITE LEGS.

MARK Nos. 150-161, 200-213,211P

**BIHAR STATE POWER TRANSMISSION COMPANY LTD**

DRAWN BY	DESCRIPTION	220KV D/C TOWER TYPE "2DA" DETAILS OF CAGE-II & BODY-I	SCALE
CHECKED BY	DRG NO	220KV-D/C-CageII-BodyI-13	-
APPROVED BY	SHEET NO	1-1	REV. 0